

ITEM 項目	PARTS NAME 零件名稱	Q'TY 數量	MATERIAL 材質	FINISH/REMARK 處理/備註
1	HOUSING	1	NYLON	(Black)
2	CONTACT	5	Phosphor Bronze	Gold flash selective
3	SHELL TOP	1	Phosphor Bronze	Gold flash selective
4	SHELL BOTTOM	1	Phosphor Bronze	Gold flash selective

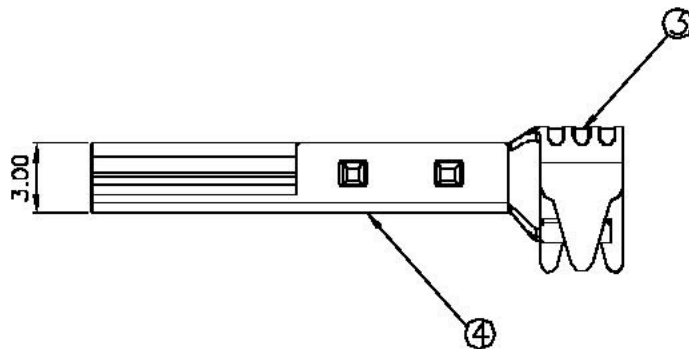
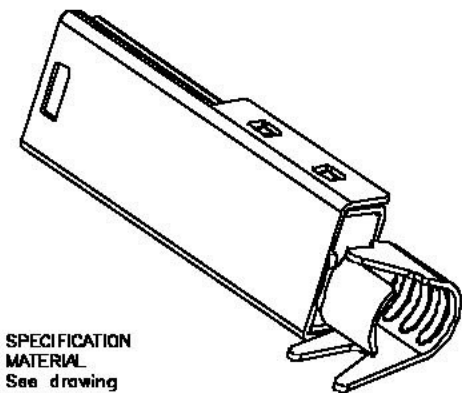
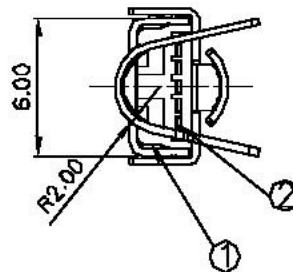
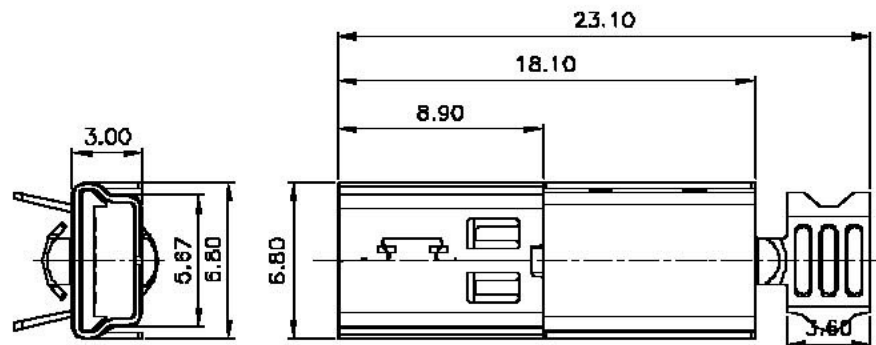

SPECIFICATION

MATERIAL
See drawing
STANDARD DATA
Rating current: 0.5A
Applicable wire: AWC#26 Max.
Operating temperature: -30°C ~ +80°C
Storage temperature: -40°C ~ +85°C
ELECTRICAL
Insulator resistance: 1000M ohms Min. @ 25D VDC
Withstanding voltage: 100 VAC / minute
Contact resistance: 50 m ohms Max.
MECHANICAL
Mating force: 3DN(3.08kgf) Max.
Unmating force (Without lock): 4.2N(0.43kgf) Min.
Durability: 10000 cycles Min.
Contact retention force: 4.2N(0.43kgf) Min

PART NO.
A 2 1 - 636 - 0501
SERIES A-Plug In
TYPE 2-0.8mm pitch
CONTACT TYPE 1=Solder type
MODEL NO. TYPE NO. 01=Type 1
CONTACT NUMBER 05=05 position

Cypress Industries

www.cypressindustries.com

	TITLE 產品名稱 PLUG IN for MOTOROLA Solder type-5 position
UNIT 單位 MM	PART NO. 產品料號 CCA21-636-0502
SCALE 比例 1.5/1	DOC. NO. 文件編號 CUT-636-XXX
REV. 版本 A	

REV. 版本	ECN NO. 換裝號碼	MARK 記號	REVISIONS 換裝內容	SIGN 修改	DATE 日期	UNLESS OTHERWISE SPECIFIED TOLERANCE 尺寸公差 X. ±0.50 .X ±0.30 .XX ±0.20 ANG. ±5'00"	CHECKED 審核	DESIGNED 設計 GJX 03/21/05"	APPROVED 承認	DRAWN 製圖 GJX 05/11/05"
1										