

△ SPECIFICATION
 Housing: LCP Glass Fibre, UL94V-0, Black
 Contact: C2680
 Gold Flash On Contact Area
 Tin Plated On Solder Tail
 Under Plated Nickel
 Shell: C2680, Nickel Plated
 RoHS Compliant

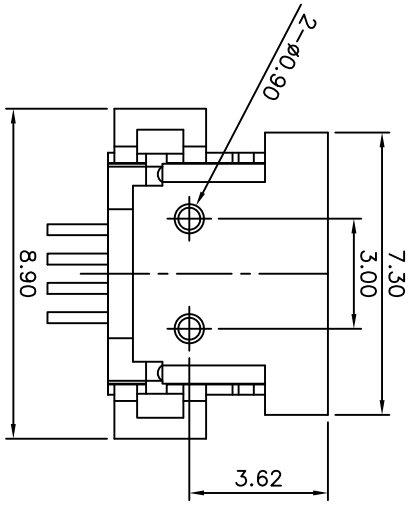
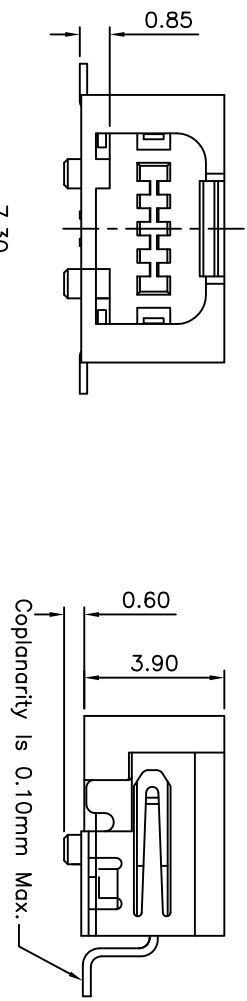
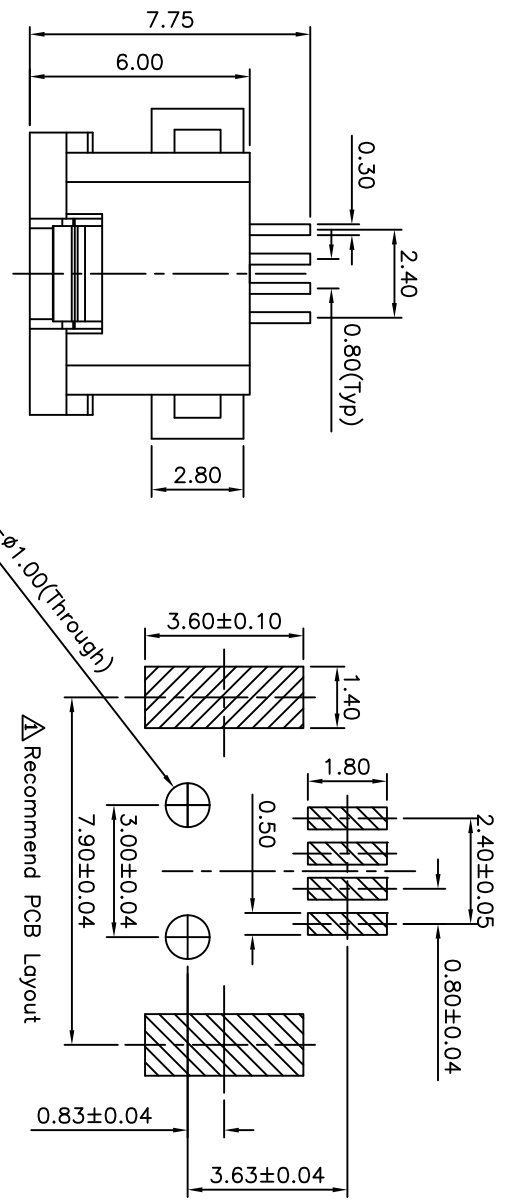

CYPRESS
INDUSTRIES

CATEGORY		APPROVED BY		UNLESS OTHERWISE SPECIFIED TOLERANCES ARE	
PART No. CCMUSB-32005-05		MEI		Δ .X ±0.10 X, ±1° .XX ±0.05 .X ±0.5° .XXX ±0.02 .XX ±0.02°	
DRAWING No. MSB1X04SWB2-H		HZF		Δ A0 A1	
SCALE NONE		REV. A1		NO. REV. A0 NEW RELEASE REVISIONS	
		QJQ		A1 Modify Data HZF 06/08/2010 SHIN 08/15/2007 CHK	
		A1		DATE	